

# CONFERENCE LOGISTICS NOTE

## General Information & Conference Logistics

**Dates:** April 20<sup>th</sup> - 23<sup>rd</sup> 2022

*“Towards Innovation and Advancement in Oncology & NCDs Care in Sub-Saharan Africa”*

Dear Participants,

Below you will find useful information on the conference venue, arrival/departure, visa requirements, accommodation, meals and other information concerning the 2022 AnCHOR Conference. We kindly ask you to take 5 minutes of your time to go through the information carefully.

### **Background**

International Cancer Institute (ICI) has organized its first Inaugural Annual Comprehensive Hematology & Oncology Review (AnCHOR) Conference that aims to bring together researchers, practitioners, educators, and scholars at all levels with interests in medical and clinical oncology, hematology and NCDs from across Sub-Saharan Africa (SSA) and around the world. The 2022 AnCHOR Conference will provide a platform for all the participants to share their case reports, articles, ideas, and publications, as well as give them each the opportunity to participate in workshops to further their education and skills. There will also be exhibitions of some of the latest advancements in cancer and NCDs care for the professionals to observe and interact with.

### **Conference Venue & Dates**

The 2022 AnCHOR Conference will take place from Wednesday 20<sup>th</sup> April 2022 to Saturday 23<sup>rd</sup> April 2022. The conference will be held in Eldoret, Kenya at the EKA Hotel, Rupa’s Mall, along Uganda Road (<https://ekaeldoret.com>). The conference will start at 08:30 am EAT on Wednesday 20<sup>th</sup> April 2022 and will end on Saturday 23<sup>rd</sup> April 2022 no later than 01:00 pm EAT. Therefore, you should plan to arrive in Eldoret no later than the evening of Tuesday 19<sup>th</sup> April and depart not earlier than the afternoon of Saturday 23<sup>rd</sup> April.

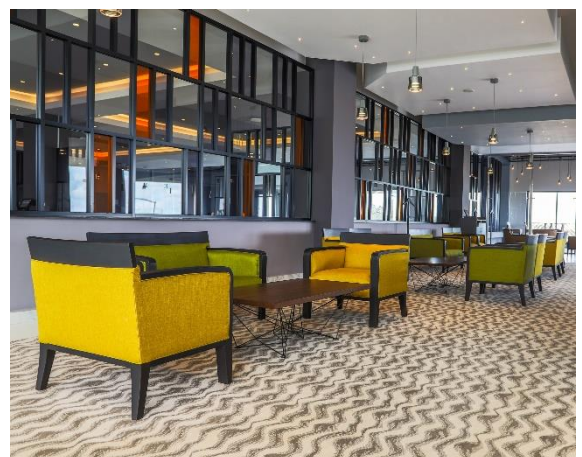

## **Registration to the Conference**

In order to attend the workshop all participants must register online using the link: <https://anchor.intercancer.com/registration/>. If you have not done so yet, please register online by 1<sup>st</sup> April 2022.

## **Registration at the Conference Venue**

Onsite conference registration will be done from Tuesday, 19<sup>th</sup> April 2022 as of 14:00 hours and throughout the week during the conference working hours.

Participants are encouraged to take advantage of the registration on Tuesday afternoon. Please bring with you an identification document with picture (i.e. ID or passport) and this letter to facilitate your entry to the conference premises and to ensure prompt on-site registration.

## **Welcome Reception**

A welcome reception for the conference guests and participants will be done on Tuesday, 19<sup>th</sup> April 2022, 17:00 - 19:00 hours at the EKA Hotel, Eldoret.

## **Conference Dinner**

The conference networking dinner will be held on Friday, 22<sup>nd</sup> April 2022 at the Boma Inn Hotel which is located 2.1 kilometers from the Conference venue.

Transportation: Buses will be available to transport participants to and from the designated hotels. More details will be available upon the in-person registration in Eldoret.

## **Conference Program/Schedule**

The final program is available on the AnCHOR conference website <https://anchor.intercancer.com/schedule/>. You can also download it [here](#).

## **Visa and Passport information**

Participants who are not nationals of Kenya or any of the countries of the East African Community will need to obtain a visa at the Kenyan embassy or consulate prior to departure. Please note that it is your responsibility to find out visa requirements and to ensure that you comply with the conditions to enter Kenya. Designated participants who require a visa to enter Kenya should submit the necessary application to the nearest in-country Visa office as soon as possible or at least four weeks before the intended date of their travel to Kenya. If required, the organizers of the conference will issue an invitation letter confirming that you are attending the conference. Please liaise with the team at [anchor.registrations@intercancer.com](mailto:anchor.registrations@intercancer.com) for further information.

More information regarding the visa and travel requirements can be found on the following websites; however, we strongly advise you to call and verify the latest information with the closest Kenyan embassy or consulate:

- <https://evisa.go.ke/evisa.html>
- <https://immigration.ecitizen.go.ke/index.php?id=5>

All non-citizen air travelers are required to be fully vaccinated against COVID-19 and to provide proof of vaccination prior to boarding a flight to Kenya. Ensure to check the MOH Kenya COVID-19 travel related requirements [here](#).

## Accommodation & Per Diem

Participants are responsible for their own flights, accommodation and per diem/daily subsistence allowance. All hotel bookings and payments must be done by the participants or funding entities. Participants are expected to make their own travel and hotel arrangements. The local organizers have negotiated accommodation at special rates at the following hotels:

### 1. The EKA Hotel (Conference Venue)

<https://ekaeldoret.com>

70 standard rooms have been blocked from 19<sup>th</sup> to 24<sup>th</sup> April 2022.

#### *Charges & Rates:*

74.00 USD for a Standard room without breakfast, single occupancy. Extra 20 USD for single occupancy per room per night with bed & breakfast. USD 113 is applicable for double occupancy with breakfast included. All rates are tax inclusive.

### 2. The Boma Inn Hotel (2.1 Kilometers from Conference Venue)

<https://www.theboma.co.ke/boma-inn-eldoret.html>

30 standard rooms have been blocked from 19<sup>th</sup> to 24<sup>th</sup> April 2022.

#### *Charges & Rates: (All rates are tax inclusive).*

Room Category	Single Occupancy (USD)		Double Occupancy (USD)	
	Bed and breakfast	Half board	Bed and breakfast	Half board
Superior Room	65.00	88.00	83.00	127.00
Deluxe Room	92.00	114.00	110.00	154.00
Governor's Suite	252.00	274.00	252.00	296.00

**3. Noble Hotel (1.8 Kilometers from Conference Venue) <https://thenoble.co.ke/>**

*Charges & Rates:* (All rates are tax inclusive).

Room Category	Single Occupancy (USD)		Double Occupancy (USD)	
	Bed and breakfast	Half board	Bed and breakfast	Half board
Standard Room	37.00	46.00	48.00	65.00
Deluxe Room	44.00	53.00	54.00	72.00
Executive Room	62.00	70.00	81.00	98.00

**4. Comfy Hotel (1.7 Kilometers from Conference Venue) <https://comfyinneldoret.com/>**

*Charges & Rates:* (All rates are tax inclusive).

Room Category	Single Occupancy (USD)	
	Bed only	Bed and breakfast
Standard Room	27.00	31.00
Deluxe Room	44.00	48.00
Executive Room	44.00	48.00

### **Travel & Transportation to/from the Airport**

The participants are responsible for their own transportation, including to/from the airport and to/from the venue.

#### **Option 1: Taxi service**

Taxis are permanently available in front of the arrivals section of the airport. The fare from the airport to the Eldoret town centre is normally around Ksh.1,600 (USD 14.00). Licensed taxis can be recognized by their signature yellow colors. Travelers are strongly advised to avoid unlicensed taxis. For alternative discounted taxi rates (USD 11.00) and pre-arranged taxi options you can contact our travel logistics partners Mangrove Tree Tours & Travel (<http://mangrovetreetravel.com/>) through +254724937567, +254722742515 or +254721215074.

### **Health Insurance**

All non-Kenyan participants are advised to travel with comprehensive travel insurance as a matter of routine and to declare any underlying health conditions to their travel insurer. This health insurance should include coverage for changes to the itinerary, emergency evacuation for health reasons, hospitalization and medical care in case of illness or accident.

## Currency

The Kenyan currency is the Shilling (KES). There are different currency exchange service shops/Foreign Exchange bureaus (bureau de change) as well as banks available at various points of the airport's arrival and departure terminals. Foreign exchange services are also accessible at the Eldoret Town Center for converting most of the major currencies.

You will be able to use ATMs at the airport and Eldoret Town Center to withdraw the local currency.

## Weather

The average temperatures you'll face in April would be between 13.0°C and 25.0°C, with a humidity rate of 67%. Check the latest weather [Here](#).

## Other

- Official Languages: English, Swahili.
- Kenya Geographical Area: 580,367 km<sup>2</sup>
- Eldoret Geographical Area: 2,955 km<sup>2</sup>
- Kenya Population: 47.6 million (2019 Census)
- Eldoret Population: 475,716 (2019 Census)
- Country dialing code: +254
- Police emergency No.: 999/911/112
- Local time: UTC/GMT +3 hours

## Internet

Wi-Fi internet access will be made available during the conference. Details on how to log in will be provided upon arrival at the conference venue.

## Power Plugs & Sockets

In Kenya, the power sockets used are of [type G](#). Your need for a power plug adapter depends on the power plugs used in your own country.

## Pre- and Post-Conference Leisure & Site Seeing Tours

There will be one complimentary half-day tour available at no cost to conference Participants to Kerio Valley for a nature trail walk and breathtaking view of the Great Rift Valley.

**Departure:** 13:00 hrs on Friday 22<sup>nd</sup> April 2022 and **Return:** Same day at 17:00 hrs.